

**TAKE PART IN THE  
CNC REVOLUTION**

**TeximpAutomation**



[www.teximp.com](http://www.teximp.com) / **Teximp®**

## Index

Universal Robot Cell .....	3
Fanuc Industrial Robots .....	4
Fanuc Industrial Cabinets .....	5
Included Fanuc Options (loaded in A- / M- Cabinet).....	5
DCS Dual Check Safety Position / Speed Check.....	5
Soft Float.....	6
Touch Skip.....	6
Payload Identification.....	6
Included Interface .....	6
TRI-Haas CHC / NGC (Depending on the machine control).....	6
TGI-A .....	7
Included Gripper.....	7
Included Auto Door .....	8
Included Safety Options .....	8
Cage instead of Omron laser .....	8
Included Pallet Table .....	9
Standard color .....	10
Programing Option .....	11
Storage Option .....	12
Pallet Option .....	12
URC Double pallet table .....	13
Pneumatic Auto Door Option.....	14
Recommended machine options .....	14
Clamping Options .....	15
Pneumatic Rotary Union .....	16
0- point clamping system .....	16
Machine Size In Relation To The Robot Cell.....	17



# TAKE PART IN THE CNC REVOLUTION

## Universal Robot Cell

Cell Model	Laser fence Price in EUR
<b>Automation Cell URC-7</b> based on LR Mate 200iD (7kg)	45'185.00
<b>Automation Cell URC-7L</b> based on LR Mate 200iD/7L (7kg)	46'865.00
<b>Automation Cell URC-10</b> based on M10iA/10M (10kg)	49'920.00
<b>Automation Cell URC-20</b> based on M20iA/20M (20kg)	54'620.00
<b>Special EDU discount for School/Education institutions</b> Incl. Installation and training free of charge	15% (on URC Cell)

\* Recommended machines see "URC fit configurator"



Not included are the local VAT, Transport, Installation and Training  
The indicated prices are only valid if purchased with a new machine



# TAKE PART IN THE CNC REVOLUTION

## Fanuc Industrial Robots



### Industrial robot type "LR Mate 200iD"

- 6-axis vertical robot
- Load capacity 7 kg / reach 717mm
- Compliance with EC Machinery Directives (CE mark)

### Industrial robot type "LR Mate 200iD/7L"

- 6-axis vertical robot (long arm)
- Load capacity 7 kg / reach 911mm
- Compliance with EC Machinery Directives (CE mark)



### Industrial robot type "M10iA/10M"

- 6-axis vertical robot
- Load capacity 10 kg / reach 1422mm
- Compliance with EC Machinery Directives (CE mark)

### Industrial robot type "M20iA/20M"

- 6-axis vertical anthropomorphic robot
- Load capacity 20 kg / reach 1813mm
- Compliance with EC Machinery Directives (CE mark)





# TAKE PART IN THE CNC REVOLUTION

## Fanuc Industrial Cabinets



**Fanuc A- Cabinet**

**Fanuc M- Cabinet**



## FANUC iPendant touch



## Included Fanuc Options (loaded in A- / M- Cabinet)

Option	Type
DCS Position/Speed check function (J567)	Software
Soft float (J612)	Software
Touch Skip (J921)	Software
Payload Identification (J669)	Software

## DCS Dual Check Safety Position / Speed Check

The Dual Check Safety (DCS) Position Speed Check software is a TÜV certified electronic safety control system for FANUC robots. It safely monitors robot speed and position in joint and cartesian coordinates. It enables operator workstation to be positioned within the robot work envelope and allows to restrict the robot motion safety within a minimum of floor space.

It allows the creation of safe zones close to the robot center, where this would be difficult.

To realize using limit switches. It restricts the robot motion safely, within a minimum of floor space. Note: The safety ratings of the robots is in accordance to the ISO 13849-1 Category 3, PL=d (Performance Level)

### Benefits:

- Improve operator safety
- Reduce system costs
- Minimizes floor space needs for the robot system

## Soft Float

The Soft Float function supports soft load/unload operation. When using the soft Float motion instruction the robot servo control is softened to minimize reactive forces and avoid damages and scratches on the workpiece.

The function High Performance Soft Float is also included for extracting workpieces softly and fast out of injection moulding or die casting machines.

Benefits:

- Minimize reactive forces during load/unload operations
- Avoid damages of tooling and robot and scratches on the workpiece
- Speed up cycle times for workpiece extraction

## Touch Skip

Touch Skip is a function, which uses internal servo data to detect when and where the robot touches an object. This function can be used to avoid collisions or detect the work piece location without any external sensor.

Caution: excessive collision may affect robot lifetime and require additional maintenance measures. Benefits

- Cost efficient work piece location and checking (without any external sensor or limit switch)

## Payload Identification

The Payload Identification function measures and sets the robot payload using an adjustable test motion of the robot axes J5 and J6.

Benefits

- Speed up cycle times
- Minimize vibrations and stress on robot and tooling
- Improve system uptime

## Included Interface

Option	Type
TRI-Haas CHC / NGC	Teximp Robot Interface for Haas
TGI-A	Teximp Gripper Interface - Air

## TRI-Haas CHC / NGC (Depending on the machine control)

Incl. all needed cables / connectors on machine side

Min. request 1 free M relays on mill / or min. 4 M relays for lathe. We recommend to add the Haas option 8M.

## TGI-A

- Cable from FANUC, cable and connector bus
- 2x 24VDC air el. Mag. valve for double catcher, output fi 6mm
- 1x 24VDC air el. Mag. blowing valve
- Recovery button, manually unclamping the workpiece
- Air hoses and couplings
- Gripper opened/closed sensors
- Aluminum block, air cushion carrier 90° for 2 gripper and air jets in the middle

## Included Gripper

For LR200iD	Type
2x JGP 80-2	Schunk Parallel Gripper
2x Set ABR-PGZN-plus 80	Schunk Gripper Aluminium
4x prepared jaws and 1x calib. pin 20mm	Calibration Set

For M10iA and M20iA	Type
2x JGP 100-2	Schunk Parallel Gripper
2x Set ABR-PGZN-plus 100	Schunk Gripper Aluminium
4x prepared jaws and 1x calib. pin 20mm	Calibration Set

### JPG 80-2/100-2

Universal 2-finger parallel gripper of the compact class with T-slot guidance and best cost-performance ratio



#### JGP80-2

- max. piece weight 4,3kg / gripper
- stroke per jaw 4mm (total 8mm)

#### JGP100-2

- max. piece weight 6,85kg / gripper
- stroke per jaw 5mm (total 10mm)



### ABR/SBR-PGZN-plus 80/100

Blanks made of aluminum for rework by the customer

# TAKE PART IN THE CNC REVOLUTION

## Included Auto Door

Option	Type
PAD-HaasVFxx-side	Pneumatic Auto Door
PAD-HaasVFxx-front	Pneumatic Auto Door
PAD-HaasMM-front	Pneumatic Auto Door
PAD-HaasSTxx	Pneumatic Auto Door

Pneumatic Auto Door according to the machine model



Example: PAD-HaasVFxx-side

## Included Safety Options

Safety Options	Type
Laser	Omron Laser
Light Curtain	Omron Light Curtain



Omron Laser

## Cage instead of Omron laser

All URC cells can also be delivered in the "Cage" version.

This variant is suitable for tight spaces or highly frequented areas.

Price of cells remains identical.

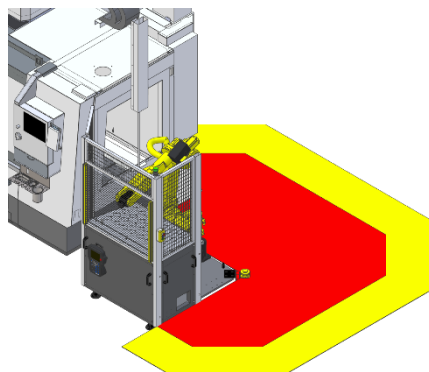
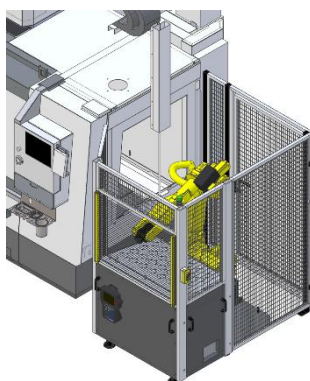

Omron Light Curtain





# TAKE PART IN THE CNC REVOLUTION

## Included Pallet Table

Option	Type
TPT	Pallet Table 980 x 700mm



Included 3 sizes of matrix plates – quick setup

- 60 pockets (10 x 6), max. Ø 35mm
- 28 pockets (7 x 4), max. Ø 65mm
- 15 pockets (5 x 3), max. Ø 95mm

Part height: 5mm - 150mm

Matrix programming using variables through Fanuc iPendant Omron  
safety laser/scanner, 2 zones

Omron safety light curtain, allow charging of pallet when robot is running

# TAKE PART IN THE CNC REVOLUTION

## Standard color

Option

RAL 1018 (+ 6 weeks)



## Standard color

Option

RAL 7035



\* Choose between RAL 1018 and 7035, no additional costs

\*\* The delivery time increases by 6 weeks for the variant RAL 1018

[www.teximp.com](http://www.teximp.com)

**Teximp®**

# TAKE PART IN THE CNC REVOLUTION

## Programing Option

Option	Type
VPD - Visual Programming Dialog	Through Fanuc iPendant

## VPD - Visual Programming Dialog

- Easy visual programming
- No additional hardware needed

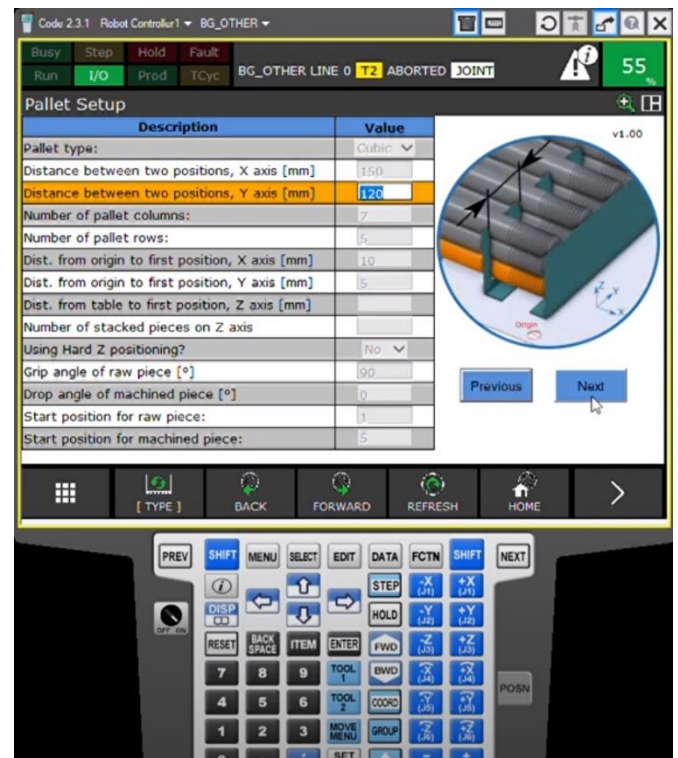





# TAKE PART IN THE CNC REVOLUTION

## Storage Option

Option	Type	Price in EUR
Storage Option	Handling	800.00

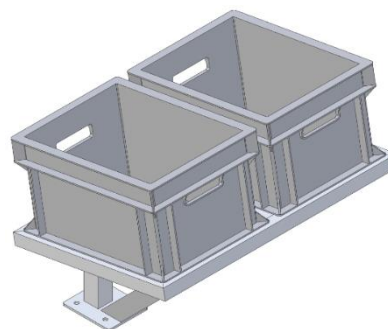
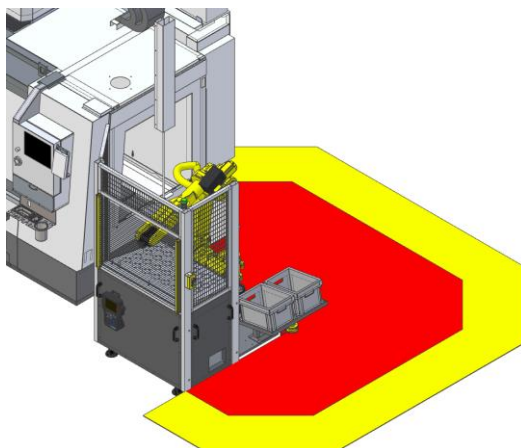

Dimensions of box:  
400x300x220 mm

## Pallet Option

Option	Type	Price in EUR
Pallet Option	Handling	800.00

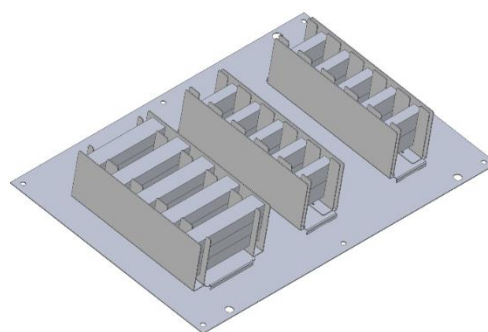
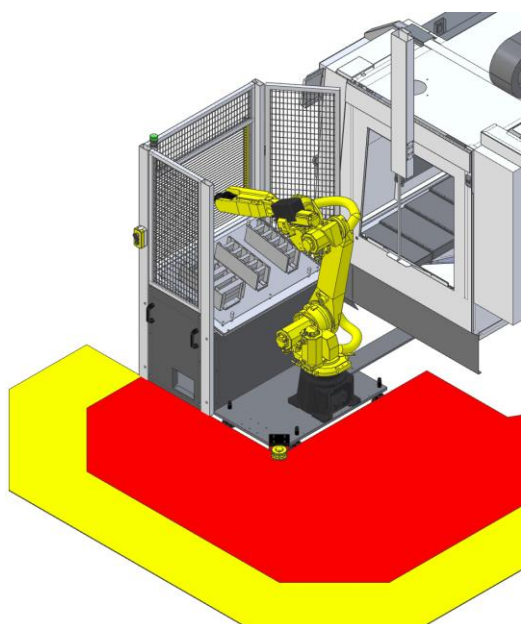





**TAKE PART IN THE  
CNC REVOLUTION**

## URC Double pallet table 90°

Option	Type	Price in EUR
Double pallet table 90°	Handling	5'995.00

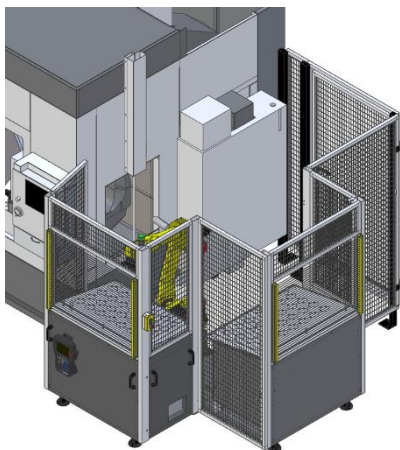

Compatible with: URC-10, URC-20

Note: Omron Laser is not compatible with this option

## URC Double pallet table 180°

Option	Type	Price in EUR
Double pallet table 180°	Handling	5'995.00

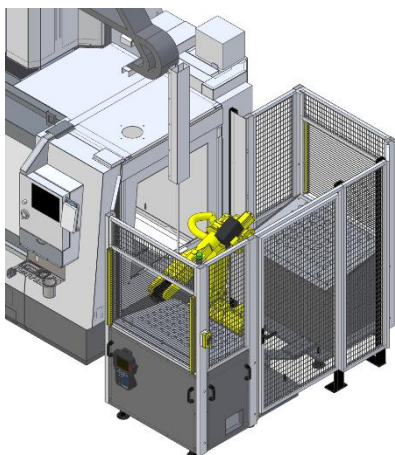

Compatible with: URC-10, URC-20

Note: Omron Laser is not compatible with this option

## Pneumatic Auto Door Option

Option	Type	Price in EUR
PAD-HaasMM-side	Pneumatic Auto Door Option for side load	1'200.00
PAD-HaasDM-side	Pneumatic Auto Door Option for side load	1'200.00
PAD-HaasUMC750-side	Pneumatic Auto Door Option for side load	1'500.00
PAD-HaasUMC1000-side	Pneumatic Auto Door Option for side load	1'500.00

## Recommended machine options

Option (Haas)	Type
8M	8 additional spare M-code relays Activated via M-codes Simplifies integration with aftermarket accessories
JET	Auto Jet Air Blast; keeps the workpiece and work holding clear of chips, without having to open the operator door
Haas Connect	Don't guess, view live machine status
WiFi Camera	View your machining remotely

## Clamping Vice

Option	Type	Price in EUR
AMP-150G/HV	Kemmler Pneumatic Vice	3'035.00
AMP-200G/HV	Kemmler Pneumatic Vice	3'880.00

### AMP-150G/HV - 200G/HV



- Suitable for mass production
- Clamping positions: horizontal and vertical
- The steel body is hardened and grinded all-round
- Integrated pull-down mechanism
- Vice modification: 1 Set of pneumatic valve for A+B line

Option	Type	Price in EUR
KSP-Z PLUS 100 + KTR-H 100	Schunk Pneumatic Vice	3'000.00



### KSP-Z PLUS 100

- Pneumatic clamping force block
- Suitable for 5 axis clamping
- Centric clamping
- Top jaw blanks
- Z-version
- Base



## Clamping Rotary Air Chuck

Option	Type	Price in EUR
RTS-05	3 Jaw Pneumatic Chuck 182mm	1'995.00
RTS-06	3 Jaw Pneumatic Chuck 215mm	2'095.00
RTS-08	3 Jaw Pneumatic Chuck 255mm	2'595.00
RTS-10	3 Jaw Pneumatic Chuck 300mm	3'295.00
RTS-05T	2 Jaw Pneumatic Chuck 182mm	2'195.00
RTS-06T	2 Jaw Pneumatic Chuck 215mm	2'350.00



RTS-T

RTS

### RTS/T

- 2 & 3 Jaw Pneumatic Chuck
- Dust and Liquid proof cover
- Built in Check Valve

## Pneumatic Rotary Union

Option	Type	Price in EUR
PRU-UMC750	Pneumatic Rotary Union	4'995.00
PRU-UMC1000	Pneumatic Rotary Union	4'995.00

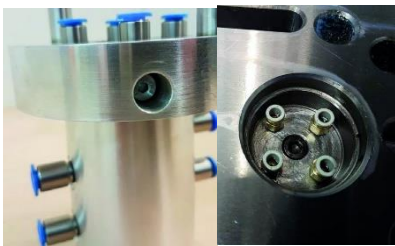

### Pneumatic Rotary Union

- Required option for Haas UMC-750 + UMC-750SS
- Required option for Haas UMC-1000 + UMC-1000SS
- 4- Way Coupling

## 0- point clamping system

Option	Type	Price in EUR
SCHUNK 2	2x Quick-change pallet system (200x400mm)	1'900.00
SCHUNK 4	4x Quick-change pallet system (400x400mm)	3'700.00
RPV-A	Automation (A+B line)	395.00



### Schunk 0- point clamping system

- Clamping stations for general milling applications
- for extremely fast set-up processes of clamping devices

### RPV-A

- 1 Set of pneumatic valve for A+B line



## Machine Size In Relation To The Robot Cell

### URC fit configurator

Model		Load	URC-7	URC-7L	URC-10	URC-20
Haas Mill	VF-1 / VF-2 (SS)	FRONT				
	VF-1 / VF-2 (SS)	SIDE				*
	VF-3 (SS) / VF-4 (SS)	FRONT	N/A	N/A		
	VF-3 (SS) / VF-4 (SS)	SIDE	N/A	N/A	**	
	VM-2	FRONT	N/A	N/A		
	VM-2	SIDE	N/A	N/A		*
	VM-3	FRONT	N/A	N/A		
	VM-3	SIDE	N/A	N/A	**	
	DM-1	SIDE				N/A
	Mini Mill	FRONT				
	Mini Mill	SIDE				N/A
	UMC-500 (SS)	FRONT	N/A	N/A	**	
	UMC-500 (SS)	SIDE	N/A	N/A	**	
	UMC-750 (SS)	FRONT	N/A	N/A	**	
	UMC-750 (SS)	SIDE	N/A	N/A	**	
	UMC-1000 (SS)	FRONT	N/A	N/A	**	
	UMC-1000 (SS)	SIDE	N/A	N/A	**	
Haas Lathe	ST-10		***		*	N/A
	ST-15		***			N/A
	ST-20					*
	ST-25					
	ST-30		N/A			
	ST-35		N/A	N/A		

#### Notes

- \* URC may fit, but will require customization of robot code
- \*\* URC may fit, but reach is limited
- \*\*\* URC may fit, but will require specific position adjustment
- N/A Not applicable

<https://www.teximp-automation.com/layouts>

Please use the Universal Robot Cell – Request Form